



The HES Series with a capacity range of 3000 to 4000 pounds of ice per day is the preferred choice of ice machine for thousands of food service applications worldwide.

Heavy-duty industrial construction, automatic operation, energy efficiency and the best warranty in the business make the Vogt HES Series the only "clear" choice for your ice making needs.

HES Standard Features:

- 25 Year Evaporator Warranty
- Voltage - 208/230v.,3p.,60hz.
- Refrigerant 452a
- Cutter for cylinder (default) or crushed ice operation
- Copeland Performance Alert power monitor
- Electronic ice bin thermostat
- Stainless steel casings
- Integral drip pan
- Self-Diagnostic indicator light
- Water-cooled or remote air-cooled operation
- PLC Control

HES Tube-Ice Available in Two Ice Sizes:

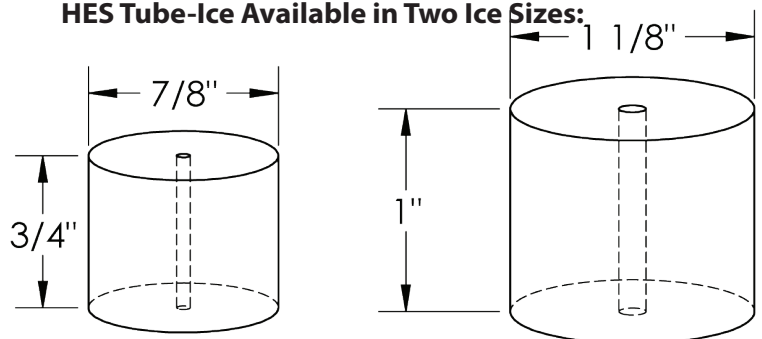

HES Series Options:

- Voltage - 460V.,3ph.,60Hz.
- Voltage - 400V.,3ph.,50Hz.
- Voltage - 200V.,3ph.,50Hz.
- High ambient air-cooled condenser
- Electro-fin coated condenser
- High pressure (200psig) water condenser/regulator
- Casing security screws (Correctional usage)
- Cutter for 1-1/2" long ice
- Remote switch box
- Flush valve assembly
- "CE" Approval (400V, 50Hz only)
- Canadian Registration Number (CRN)
- Export crating (ISPM-15 Rated)

Energy usage based on makeup water temperature of 70 ° F. (21 ° C.), ambient (air) temperature of 90 ° F. (32 ° C.). Capacity rating is average for the model. Individual machines may vary +/- 5%. Capacity based on ambient (air) temperature of 90 ° F. (32 ° C.). Capacity reduced 17% for 50hz. operation. Makeup water usage includes 20% blowdown.

Model	Machine Capacity						Water Usage				Energy Usage	
	Make-Up Temperature						Ice Making		Condenser		(KWH/100 lbs)	
	50°F (10°C)		70°F (21°C)		90°F (32°C)		Gal/100lbs	Liters/100lbs	Gal/100lbs	Liters/100lbs	Water Cooled	Air Cooled
HES-30S	3070	1393	2750	1247	2300	1043	14.5	54.9	220	833	3.32	4.11
HES-30M	2690	1220	2400	1089	2010	912			341	1291	3.63	4.82
HES-40S	4070	1846	3620	1642	3230	1465			171	647	3.38	4.24
HES-40M	3565	1617	3170	1438	2830	1284			402	1522	3.80	4.85



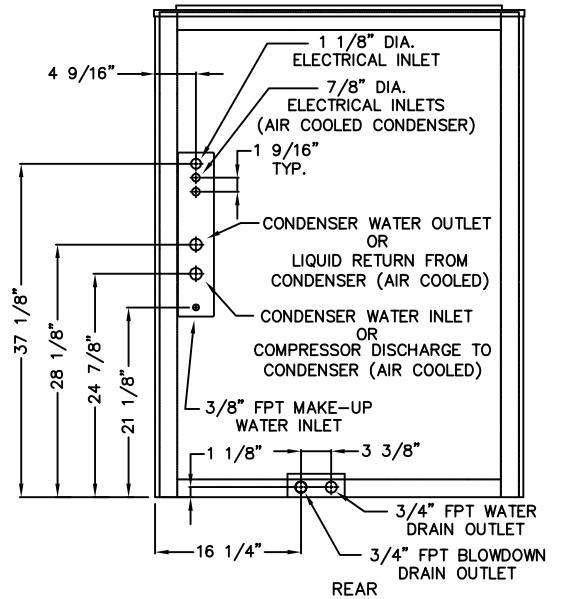
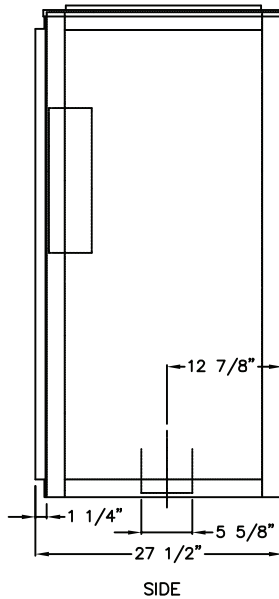
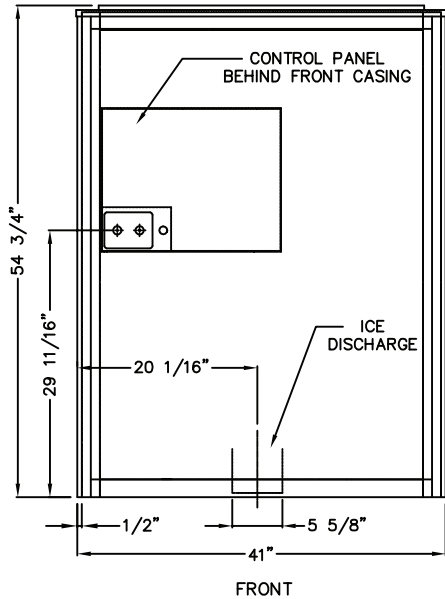

NOTE: MACHINE FOOTPRINT WITHOUT CASINGS: 40" X 26" X 54"

Model	Voltage	Ice Machine Electrical Information						Motor Information				Shipping Weight	
		Water Cooled			Air Cooled			Water Pump	Cutter Motor	Condenser Fan Motor(s)	Compressor	Lbs	Kg
		F.L.A.	Min. Ampacity	Max. Fuse Size (Amps)	F.L.A.	Min. Ampacity	Max. Fuse Size (Amps)						
HES-30	208/230V, 3ph, 60Hz	21.6	25.4	45	29.6	33.4	50	1/3	1/2	2@1/2	4	1250	567
	460V, 3ph, 60Hz	10.7	12.6	20	11.6	13.5	20						
	200V, 3ph, 50Hz	22.6	26.4	40	30.6	34.4	45						
	400V, 3ph, 50Hz	11.2	13.1	20	12.1	14.9	20						
HES-40	208/230V, 3ph, 60Hz	27.3	32.5	55	35.3	40.5	65	1/3	1/2	2@1/2	6	1275	578
	460V, 3ph, 60Hz	14.8	17.7	25	15.7	19.5	30						
	200V, 3ph, 50Hz	28.3	33.5	50	36.3	41.5	60						
	400V, 3ph, 50Hz	15.3	18.2	25	16.2	20.0	30						

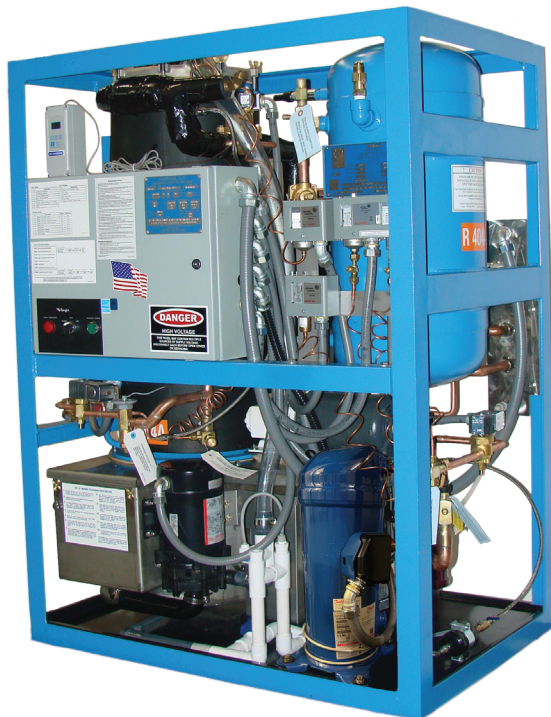

Line Size Connections		
Ice Making Water		3/8" FPT
Drain Connections	Overflow	3/4" FPT
	Drip Pan	3/4" FPT
* Condenser Water Inlet and Outlet	HES-30	3/4" FPT
	HES-40	1" FPT

** See service manual or air-cooled installation instruction packet for sizing discharge and return piping.

NOTE: * WATER COOLED MACHINE / ** AIR COOLED MACHINE

Operating Conditions

The ice machine shall not be subjected to atmospheric temperature lower than 50° F. (10° C.) nor higher than 90° F. (32C.) without effect on performance. Water for condensing or ice making purposes shall be non-corrosive.

The water shall be at a constant pressure no less than 30lbs. at the ice machine location. The condition of the water to make satisfactory ice shall be the responsibility of the purchaser.